



Honey Bee Manufacturing Ltd.
P.O. Box 120
Frontier, Sask. S0N 0W0
Phone (306) 296-2297
Fax (306) 296-2165
email: rick.norheim@honeybee.ca

SERVICE BULLETIN

MANDATORY	X
------------------	----------

FIX ON FAILURE

INFORMATION ONLY

SRV 09-010

Date: Dec. 25, 2009

Product: Grain Belt and WS, all 2009 units as well as 2008 tables after Grain Belt serial # 36GB081420 and WS serial # 36WS085450.

We have attempted to make every effort to verify the accuracy of the 08 serial number break. However in case of question or error, it should be noted that 08 requirement for change is easily identified by motor brand name. Eaton motors require replacement and Sauer Danfoss do not require replacement.

Re: Knife drive motor replacement.

Please note: This bulletin pertains to 08 and 09 Honey Bee Grain Belt and WS tables only.

Problem: Knife drive motor performance inadequate due to excess loss via motor case drain.

Solution: Replace knife drive motor/motors on double knife drive units.

Ordering Information:

Parts #	Description	Qty.
27906	Knife Drive Motor	1 (2 req. for D/D)

Labor Allowance: 2 hour.

Reimbursement: Full credit for parts as well as labor allowance will be issued **when parts have been returned** and a completed warranty claim has been submitted to Honey Bee Mfg. Ltd. Claim must include the **serial #** of the unit updated, **service bulletin number** as well as **part numbers** and **quantities** purchased.

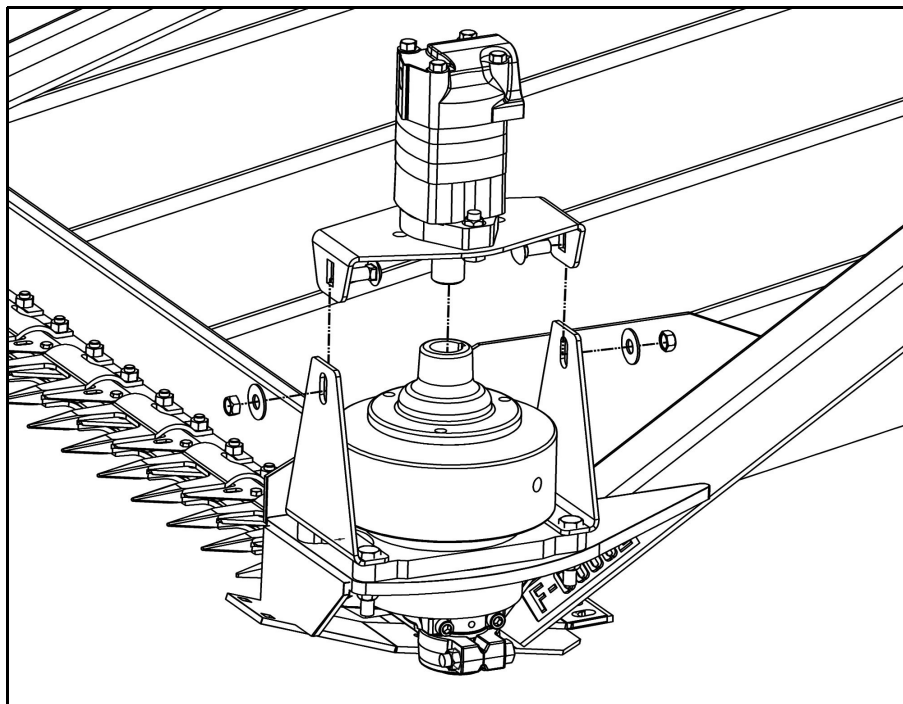
GB/WS Knife Drive Motor Replacement
Instruction for service bulletin SVR 09-010**Parts**

- Eaton Hydraulic Motor (SN – 104-4178-006)



2009 If your knife drive hydraulic motor has the same serial number as the one on the replacement motor (104-4178-006), then no replacement is required.

2008 If table is factory assembled with Sauer Danfoss motor/motors, then no replacement is required.

Safety

When working on the header, ensure that it is properly secured so it does not suddenly move or shift while you are close by.



When working with the hydraulics ensure that you have a container of some kind underneath the working area to capture any hydraulic oil that flows out of the motor and hoses.

1. Remove the crop dividers from the front of the header. This will allow better access to the knife motor assembly.

**NOTE**

The crop deflector will remain attached to the header throughout the process, however it will not be shown for clarity reasons.

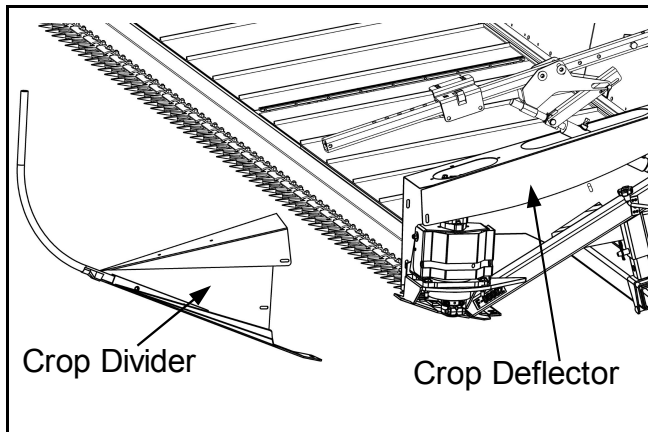

2. Remove all of the hoses and fittings from the hydraulic knife motor as shown to the right.

IMPORTANT

When removing the hydraulic hoses, be sure to mark the motor and hoses, so you know which connection goes where when installing the new motor.

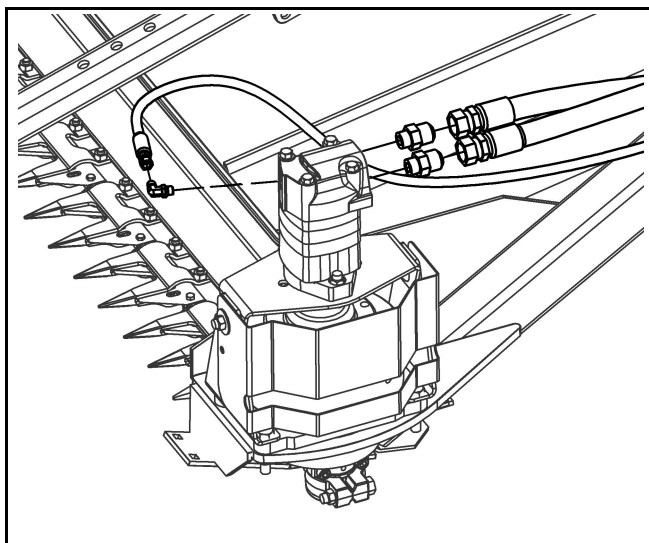

3. Remove the knife drive shield and the set screw as shown to the right.

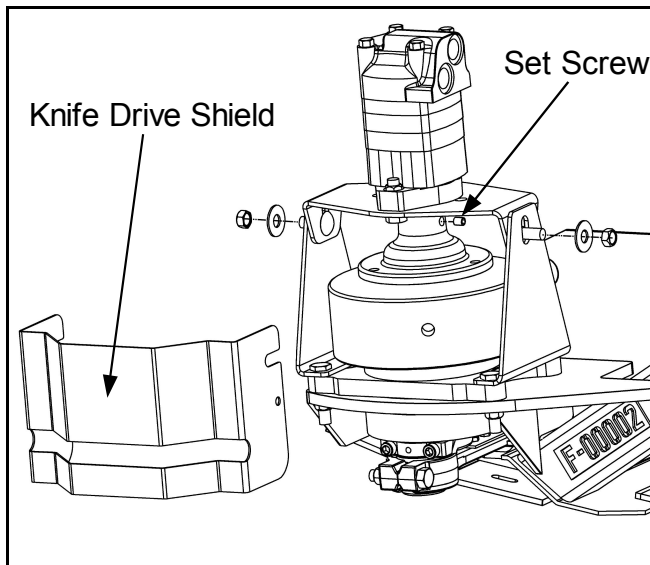

4. Remove the hydraulic motor from the knife drive assembly as shown.

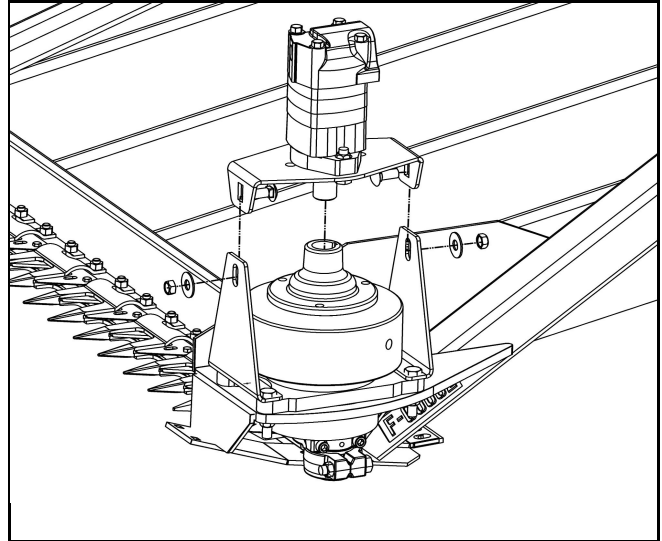

5. Remove the hydraulic motor from the knife plate as shown to the right.

Once the original motor is removed, secure the replacement motor to the knife plate. Remove the plugs from the ports that you will be connecting the hydraulic fittings to.

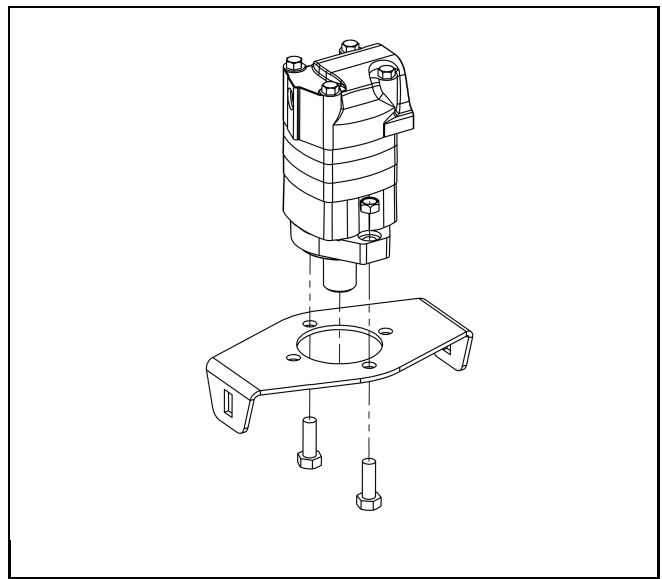

6. Reverse the previous steps to secure the new motor to the header.
 - Ensure the hydraulic hoses are securely connected.
 - The motor shaft should be coated with an anti-seize compound before inserting into the drive assembly.
 - When securing the hydraulic hoses to the new motor, pay attention to the marks that you had made earlier to ensure that the hoses are connected to the correct ports.