



Honey Bee Manufacturing Ltd.  
P.O. Box 120  
Frontier, Sask. S0N 0W0  
Phone (306) 296-2297  
Fax (306) 296-2165  
Email: [alton.norheim@honeybee.ca](mailto:alton.norheim@honeybee.ca)

## SERVICE BULLETIN

MANDATORY

FIX ON FAILURE

INFORMATION ONLY

Ref: SRV-022-001

Date: 4-20-22

**Product: 200 Series and SDX AirFlex Headers**

**Re: Drive System Tension**

**Problem:** Failure of the drive belts on the header.

**Solution:**

1. We have seen some failures of the drive belts on the AirFlex headers this past season due to improper tension. To help make certain that the belts are tensioned properly a new decal will be added to all headers. This decal shows the proper tension on the belts. (See Figure 1).

The belts still need to be tensioned using a phone with the fine tuner APP. This will assure the proper tension of the belts the following are the APP's for both the apple and android devices: Note: the app for the android phone is a new app. The previous app is no longer supported.

- <https://itunes.apple.com/us/app/fine-tuner-chromatic-tuner-for.../id877102884?mt>
- <https://play.google.com/store/apps/details?id=org.cohortor.gstrings>
- 

To use these APP's

- Hold the phone under the long span of the belts with the Fine Tuner app turned on. (Figure 2)
- Tap the belt with a large wrench 3 or 4 times.
- Read the Hertz on the phone (example in Figure 3 and 4)
- Adjust the belt to the proper tension listed on the decal.

Most of the belts require a new and used setting.

- A used belt should run 24 hours before it be classified as a used belt.
- During PDI all belts should be adjusted to the "New" setting.
- A new header should have ALL of the belts adjusted after 24 hours of operation. This includes the belts that use a spring gauge for adjustment.

**Note: The tension on the belts should be checked when the belts are at operating temperature. Checking the belts when they are cold will result in the belts not being correctly tensioned at operating temperature.**

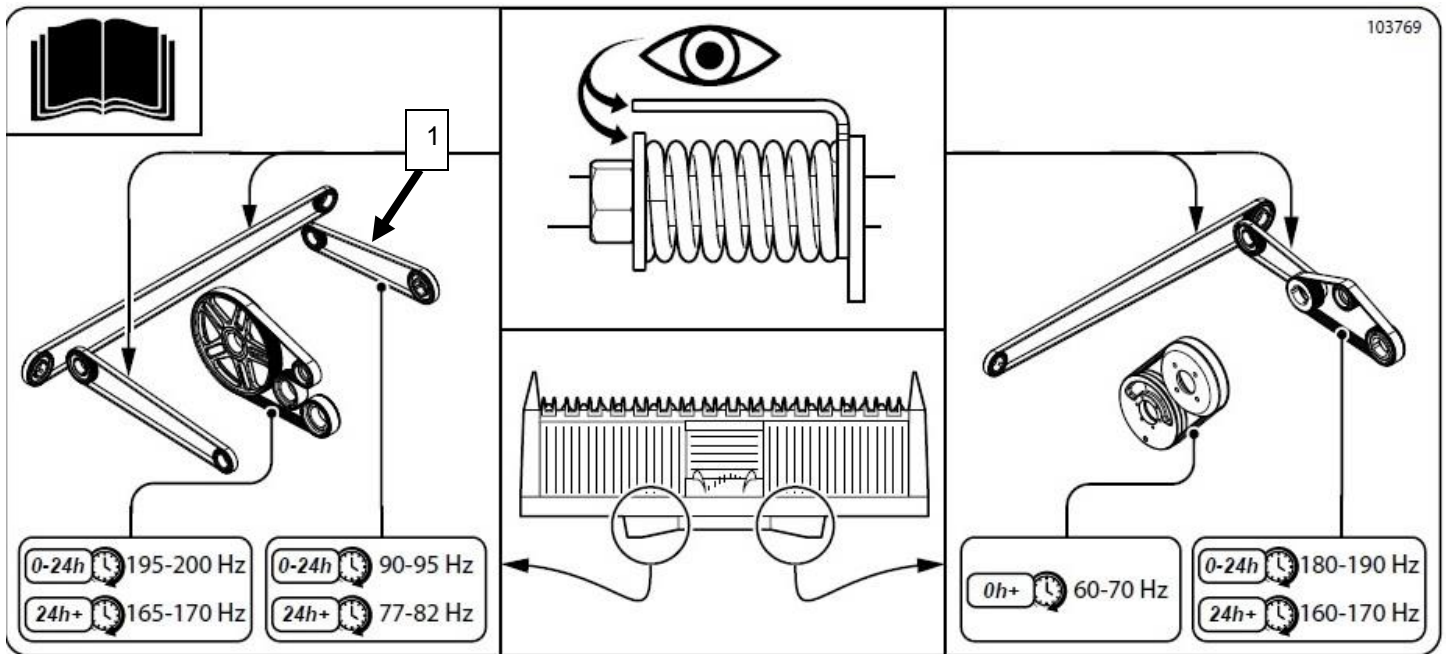

Figure 1

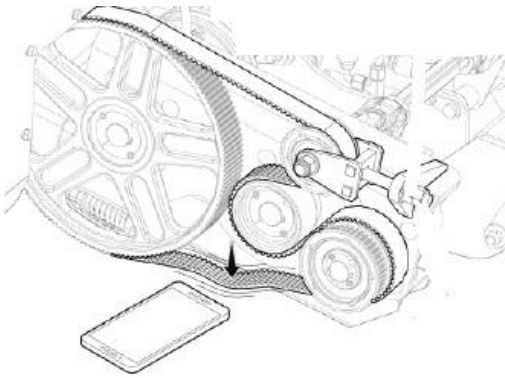

Figure 2

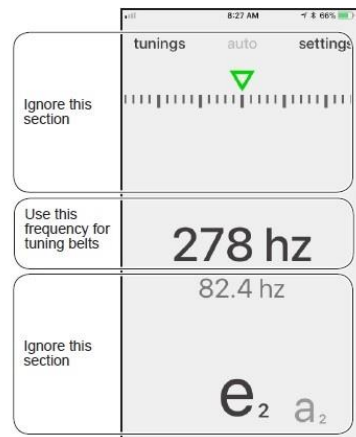

Figure 3 iPhone App

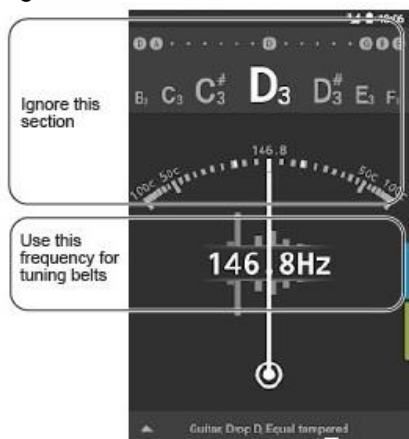

Figure 4 Android App

2. The Center Deck drive belt tension system was also changed for the Model Year 2020 headers. On past years the tension system was a spring system or in 2019 a solid link was used. The belt system was susceptible to the belt jumping the cogs on the pulleys.
  - To resolve this issue in 2020 the drive belt for the Center deck was replaced with a chain drive system
  - The kit replaces both styles of belts and belt tension systems. Figure 5

- There are two different style kits, one for Model Year 2019, and one kit for Model Year 2017 and 2018.

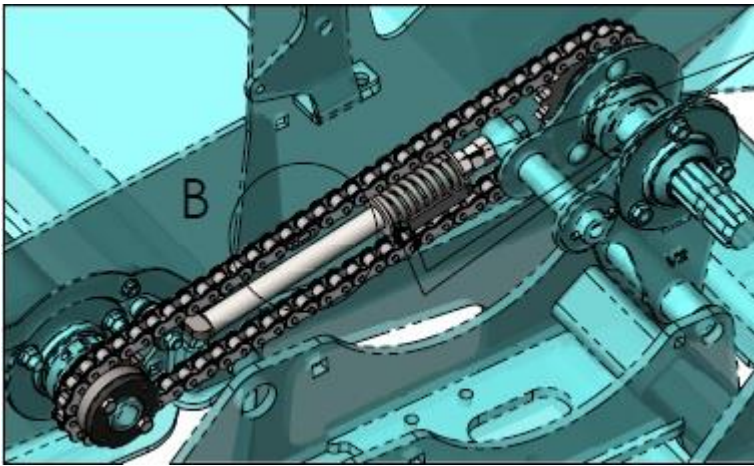

Figure 5

- The following is the kit that can be installed on Model Year 2019 headers Figure 6 with the parts list Figure 7.

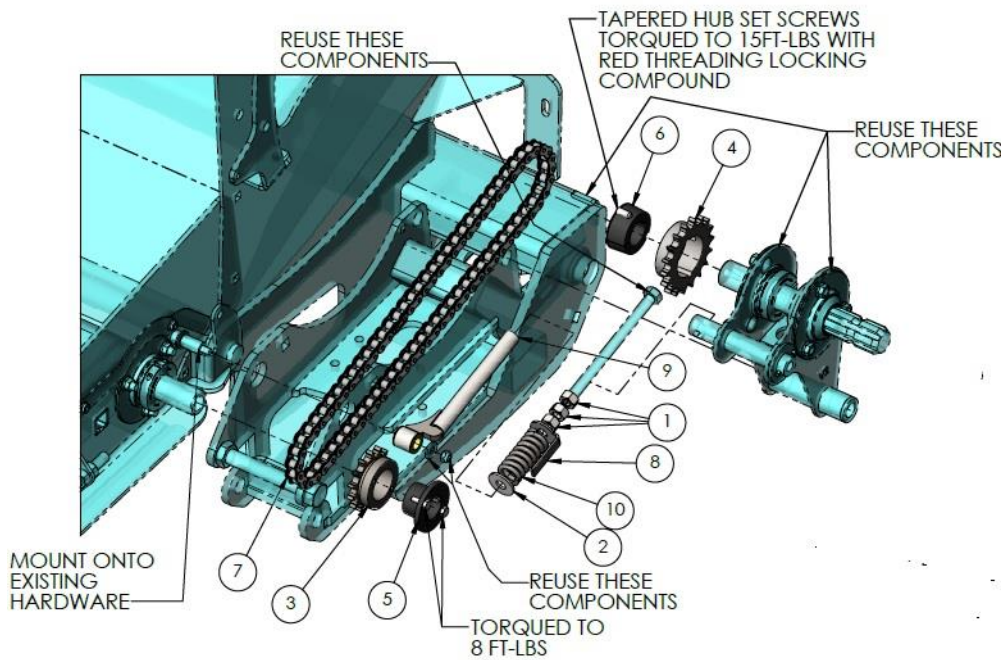

Figure 6

ITEM NO.	QTY	DESCRIPTION	PartNo
10	1	SPRG-TENSION ADJ Y-B	P83469
9	1	OFST ADJ TUBE ASSY-FDR DK CHN DRV-FLEX Y-K	G208749
8	1	IND-SPRG TENSION-FRMD Y-B	G83660
7	1	CHN RLR KIT-#50 X 46-1/4" C/W CONN LINK	208797
6	1	HUB-TPR LOCK-1610 1-1/4" C/W SET SCREWS	208748
5	1	BSHG-TPR-H1 1-1/4 C/W BOLTS & KEY	208747
4	1	SPKT H50BTB18 TPR LOCK 1610	208672
3	1	SPKT H50H14 SPLIT-TPRD	208658
2	1	WSHR FLAT 1/2	19924
1	3	NUT 1/2 UNC GR 'A'	19804

Figure 7

- The following kit can be used on Model Years 2017 and 2018 Figure 8 with the parts list for the kit Figure 9.

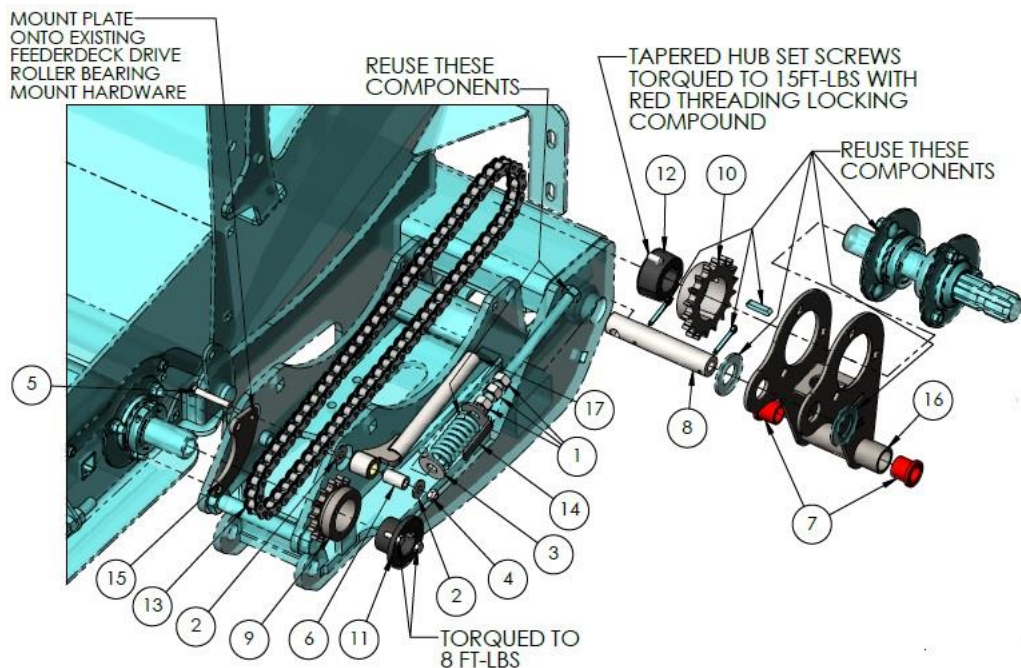

Figure 8

ITEM NO.	QTY	DESCRIPTION	PartNo
17	1	OFST ADJ TUBE ASSY-FDR DK CHN DRV-FLEX Y-K	G208749
16	1	TENSION WD-BELT-FLEX-SUSP Y-J	G205277
15	1	MNT PLT-FDR DK BELT TENSION-SUSP-FLEX Y-J	G205243
14	1	IND-SPRG TENSION-FRMD Y-B	G83860
13	1	CHN RLR KIT-#50 X 46-1/4" C/W CONN LINK	208797
12	1	HUB-TPR LOCK-1610 1-1/4" C/W SET SCREWS	208748
11	1	BSHG-TPR-H1 1-1/4 C/W BOLTS & KEY	208747
10	1	SPKT H50BTB18 TPR LOCK 1610	208672
9	1	SPKT H50H14 SPLIT-TPRD	208658
8	1	ROD-TENSION MNT-FLEX-SUSP Y-J	207174
7	2	BSHG-CMMN-RED-FLEX Y-I	203335
6	1	BSHG-DRV HD-VERT KNF-FLEX-INR Y-H	201173
5	1	BOLT 5/16 X 2 UNC CARR GR5	27247
4	1	NUT 5/16 UNC C/LOCK	19989
3	1	WSHR FLAT 1/2	19924
2	2	WSHR FLAT 5/16	19921
1	3	NUT 1/2 UNC GR 'A'	19804

Figure 9

#### Ordering Information:

Part Number	Description	Qty
103769	Belt tension decal	1
95191	Center Deck Chain Upgrade MY 2019	1
95192	Denter Deck Chain Upgrade MY 2107&2018	1

#### Labor Allowance: For information Only

The chain kit is offered as an upgrade only and not covered under warranty