

SERVICE BULLETIN

MANDATORY

FIX ON FAILURE

INFORMATION ONLY

Ref: SRV-018-010

Date: 10-3-18

Product: AirFlex 200Series and SDX Series

Problem: Proper repair and installation of the bearings on the feeder and lateral decks.

Solution: Since the Model Year 2017 a new bearing style has been installed in the feeder and lateral deck rollers. The new bearings also replaced the bearings on the 2016 and older decks. The bearing is the Peer bearing and the bearing has a different style of a lock collar. Rather than the eccentric style lock collar that is used on most bearings this bearing has a split inner race so that the collar will seat the bearing on the shaft tighter, see figure 1.



Figure 1

With the new style bearing it is necessary to make sure the shaft on the roller is not worn so the bearing will clamp to the shaft properly. If the bearing fails, the size of the shaft must be checked before a new bearing is installed.

Shaft Size

Before installing the new bearing, the size of the shaft must be checked, Figure 2

- A new shaft is 1.250" in diameter.
- If the shaft diameter is worn were the bearing sets to 1.249 nothing else is needed and the bearing can be installed.
- If the shaft diameter is 1.247 to 1.249", clean shaft and apply Loctite 648 to the shaft when installing the bearing.
- If the shaft diameter is below 1.247 a new roller must be installed.



Diameter must be 1.247 or the shaft should be replaced.

Figure 2

Installation Instructions:

Lateral Deck

- Install the one side of the roller using a 3/8" X 3/4" cap screw, lock washer and fender washer.
- Install the bearing in the slider by rotating it 90 degrees in the slot on the slide, Figure 3
- Install slider and bearing on the shaft.
- Make sure the set screws are backed out of the collar so the collar will slide on the shaft. Figure 4.

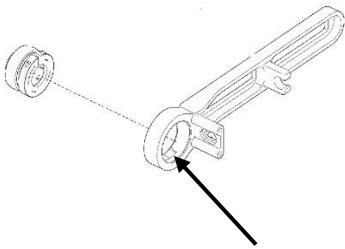

Figure 3



Figure 4

- Install the slider onto the shaft and the deck frame.
- Slide the collar on the bearing and tighten the set-screws on the collar to hold in place. Just tighten the screws enough to hold into place. DO NOT overtighten the set screws.
- Then tighten the Torx screw in the collar to 97 in.Lbs. Figure 5



Figure 5

- Assemble the remaining drive parts for the lateral deck.

Feeder Deck Drive Roll

- Install the LH bearing in the center feeder deck frame. Figure 6. Note: The collar should only be held in place by the set-screws and not clamped on the shaft.
- Insert the roller sliding the roller from the right-hand side of the frame and into the left-hand bearing. The bearing should bottom out on the shoulder of the roller.
- Install the bearing on the right-hand side of the deck frame. Lock the collar in place using the set-screws. Leave the clamp bolt loose on the collar. Figure 7
- Center the roller in the deck and tighten the torx-head screws to 97 in. lbs.

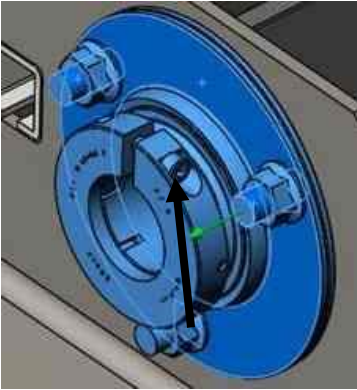

Figure 6

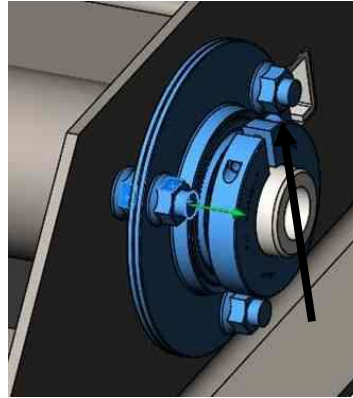

Figure 7

Feeder Deck Idler Roller

- Install the bearing in the center deck sliders by rotating it 90 degrees as shown in Figure 2.
- Install the right-hand cast slider onto the deck, Figure 8.

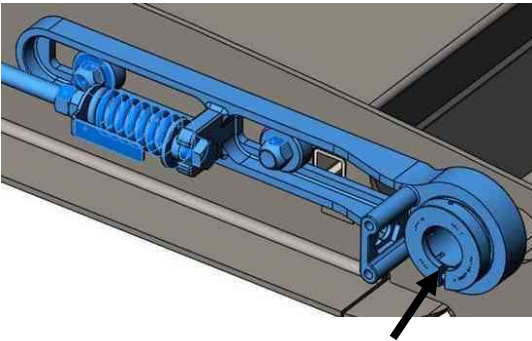

Figure 8

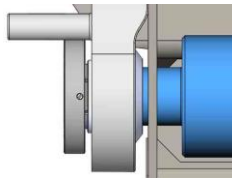

Figure 9

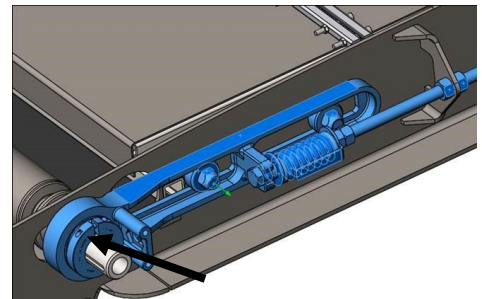

Figure 10

- Slide the idler roll into the deck frame from the left-hand side of frame. Slide the roller in so that the end of the shaft is aligned with the outside of the bearing and collar, Figure 9
- Install the left-hand slide assembly onto the idler roller, Figure 10. Align the v-guide on the idler roller with the v-guide on the drive roller. Make certain that the roller is not rubbing on the deck frame. Tighten the torx-head screws in the collar to 97 in. lbs.
- The rest of the feeder deck can now be assembled.

Ordering Information:

Note: The following are the new part numbers for the new bearing assemblies.

Part Description	Old Part Number	New Part Number
Deck Bearing	61673	202024
Feeder Deck Roll	89593	201472
Lateral Deck Roll	100116	201297
Deck Slide Assembly Includes bearing	100119	201881
Deck Slide Assembly Includes bearing	89938	201465

Labor Allowance: N/A

NOTE: