



Honey Bee Manufacturing Ltd.

P.O. Box 120

Frontier, Sask. S0N 0W0

Phone (306) 296-2297

Fax (306) 296-2165

email: rick.norheim@honeybee.ca

SERVICE BULLETIN

MANDATORY

FIX ON FAILURE

INFORMATION ONLY Y

Ref: SRV - 011-006

Date: Apr. 30, 2011

Product: All Ull reels sold on Honey Bee product.

Re: Cam roller and timing adjustments on Ull reels.

Please note: The following adjustments pertain to Honey Bee Mfg. product supplied with Ull reels, from 1984 through 2011.

Problem: Improper settings on Ull reel cam or reel timing will cause premature wear on cam ring and or reel.

Solution: Adjust cam rollers or reel timing as required.

Ordering Information: N/A.

All three rollers must be lightly touching (or very close to touching) the cast control ring, this will allow a smooth rotation of the reel.

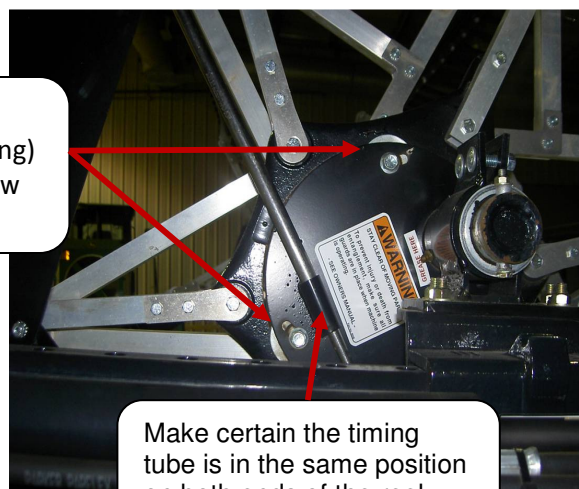

Make certain the timing tube is in the same position on both ends of the reel.

Reimbursement: N/A

Labor: N/A