

End Strut Gauge Wheel Installation Kit



End Strut Gauge Wheel Installation

Preparation

Check the contents of the kit against the shipping documents to ensure you have received all the correct parts, and that everything is in good condition. Familiarize yourself with the parts and these instructions before starting work on the installation. Read through the entire manual to get an idea of how it will go together before you start work.

If this option is being installed on a Grain Belt Header, a section of belting will be included in the kit.

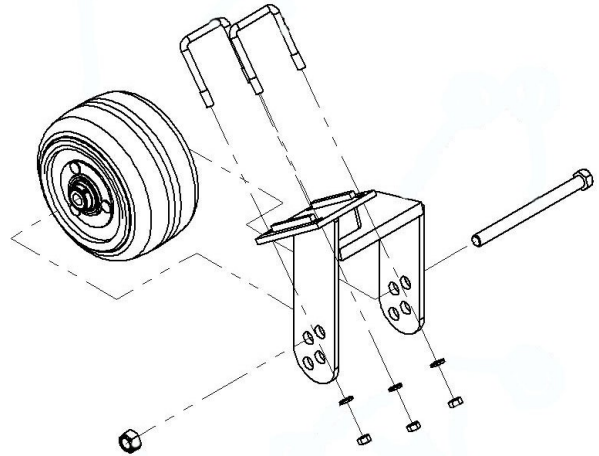

Illustration 1: End Strut Gauge Wheel Parts

Directions

For the purposes of this manual, front refers to the cutter bar portion of the header, rear refers to the crop discharge side, left and right are as seen when standing at the rear facing the front.

Installation

1. Loosen the bolts securing the deck retainers, and shift the decks inward about 6 inches. If this method does not allow the decks to move 6 inches, remove the bolt shown as “Option 2”, and relocate the retainers to prevent any interference with moving the decks.

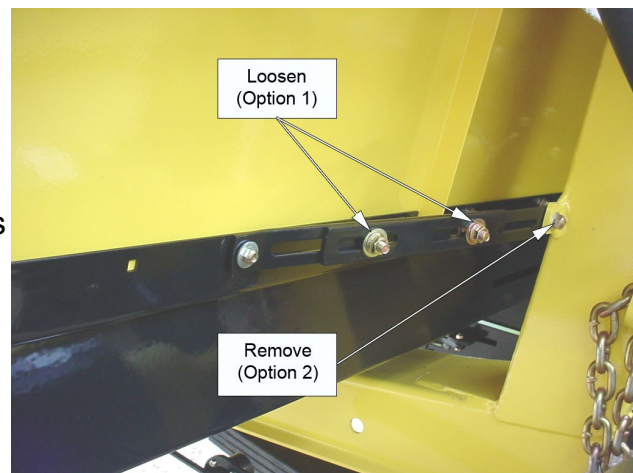

2. Measure 37 inches along the end strut as shown, and mark the strut with an appropriate liquid marker.

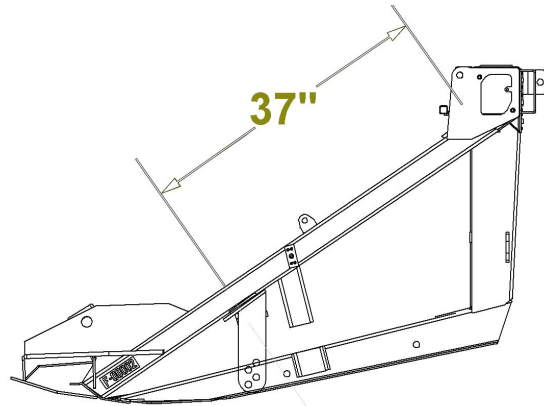

Illustration 2: End Strut - Gauge Wheel Placement

3. Select the correct gauge wheel mount (8) for each end. The offset from the clamping plate must be **inside the strut**, and the plates to which the wheel attaches must extend straight down.
4. Place the mount centered under the mark you made previously.
5. Clamp the mounts to the correct struts using the u-bolts (5), nuts (2) and washers (4) provided.
6. Attach the wheels (6) to the mounts using the $\frac{3}{4}$ x 9" bolts (1), and nylock nuts (3) provided. Select the set of holes for the bolt (1) that will give the desired cutting height.

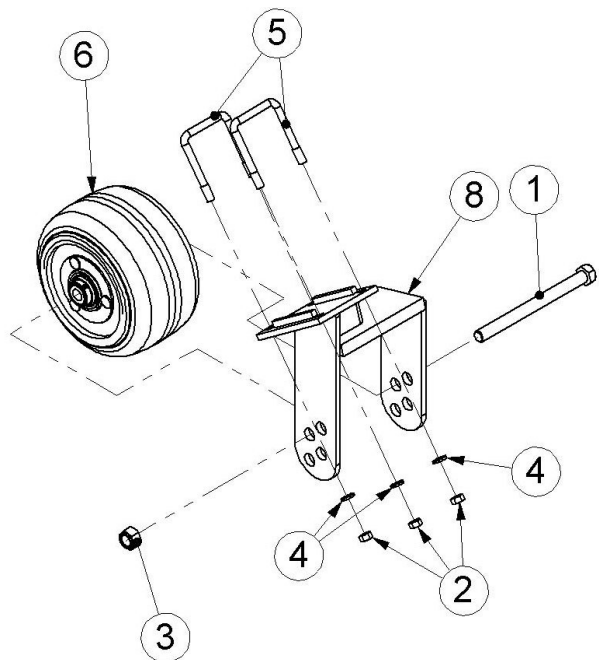

Illustration 3: End-Strut Gauge Wheel - Exploded View

7. Move the decks to provide a **minimum of 1 inch clearance** from the slats on the draper to the sides of the end-strut gauge wheel mounts.
8. Secure the retainers to the main struts using option 1, 2, or a combination of these options. If you removed the inner bolt in step 1, replace, and secure it now.
9. NOTE: It may be necessary to drill a hole into the vertical deck panel to secure the retainer.

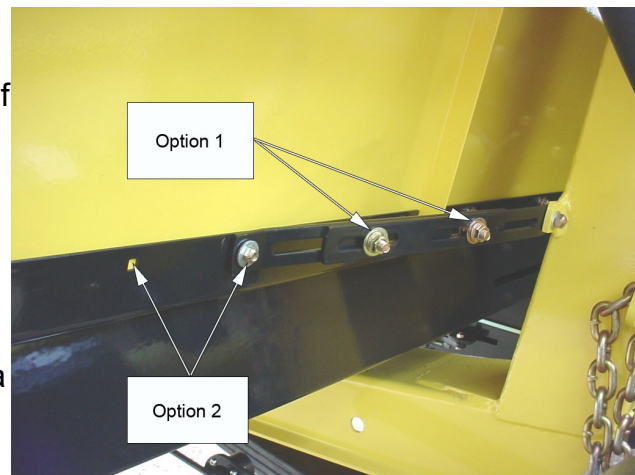

Illustration 4: Deck Retainer

10. **If you are attaching this option to a Grain Belt Header**, place the belting along the inner edge of the crop deflectors, drill at each hole in the belting, and pop-rivet the belting to the inner edge of the metal crop deflector. Ensure you place the washers under the belting, so the head of the rivet will expand against them. Using the Tech-screws provided, attach the front of the belting to the hay guard. To avoid stripping the hole out, do not overtighten.

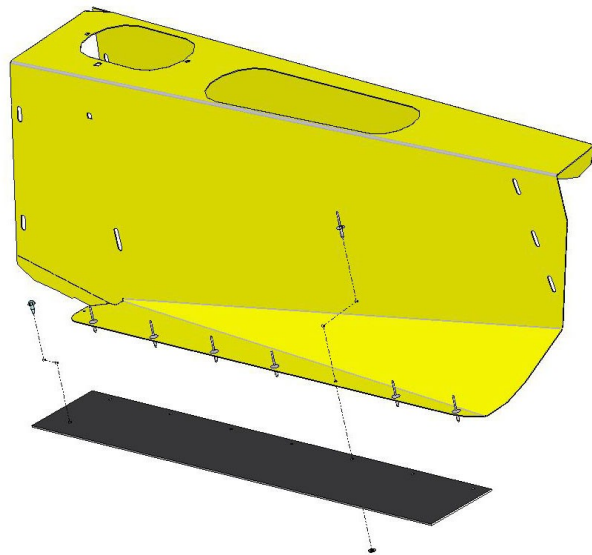

Illustration 5: Attaching the Belting

11. Test the height of the wheels by lowering the header into cutting position. The end-strut gauge wheels should be in contact with the ground, but not holding the ends of the header above the desired height. Adjust as necessary by moving the wheels up or down using the holes provided.

NOTE: You may also move the mount ahead and back on the end-strut of the header to fine tune the height of the wheel. If the header is equipped with UHMW skid plates, check for interference between the wheel and the skid plate.